

Superficie area progetto:
Piazza Albania-4380 mq.

Superficie impronta edificio:1521 mq.

Volumetria-20000 mc. ca.

Richieste di progetto:

a)2 sale conferenze per un totale di 500 mq.

b)zona commerciale:600 mq.

c)ristorante:400 mq.

d)galleria+bookshop+caffetteria:1500 mq.

e)uffici:250 mq.

totale 3500 mq. ca.

Dati metratura progetto:

sala conferenza 1:216 mq.

sala conferenza 2:319 mq.

zona commerciale:436 mq

ristorante:389 mq.

galleria+bookshop+caffetteria:1654 mq.

h. max.:22,50 m.

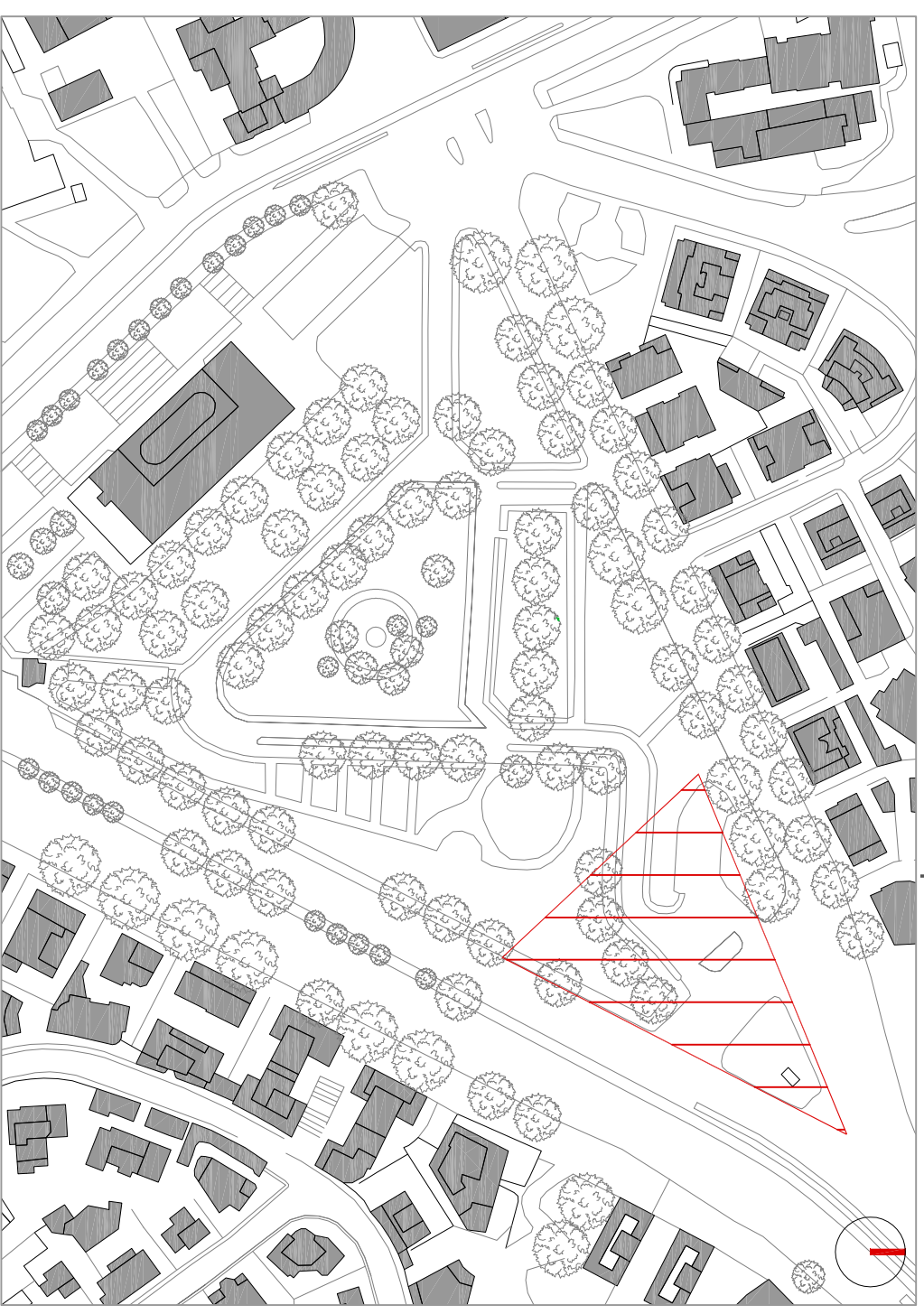

planimetria scala 1:2000

1-mass

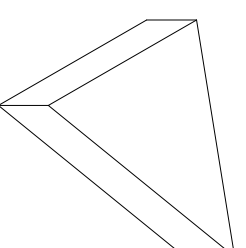

2-rifle

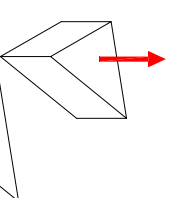

Concept

3-broke

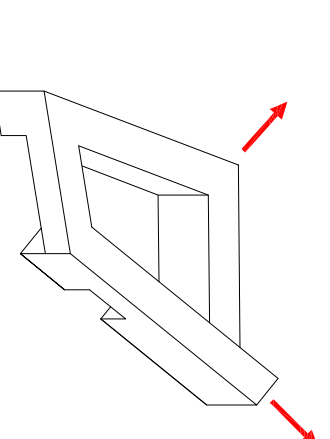

4-space

