

IDEA GENERALE DI BIBLIOTECA (PIANTA - FRENTE)
E: 1/800

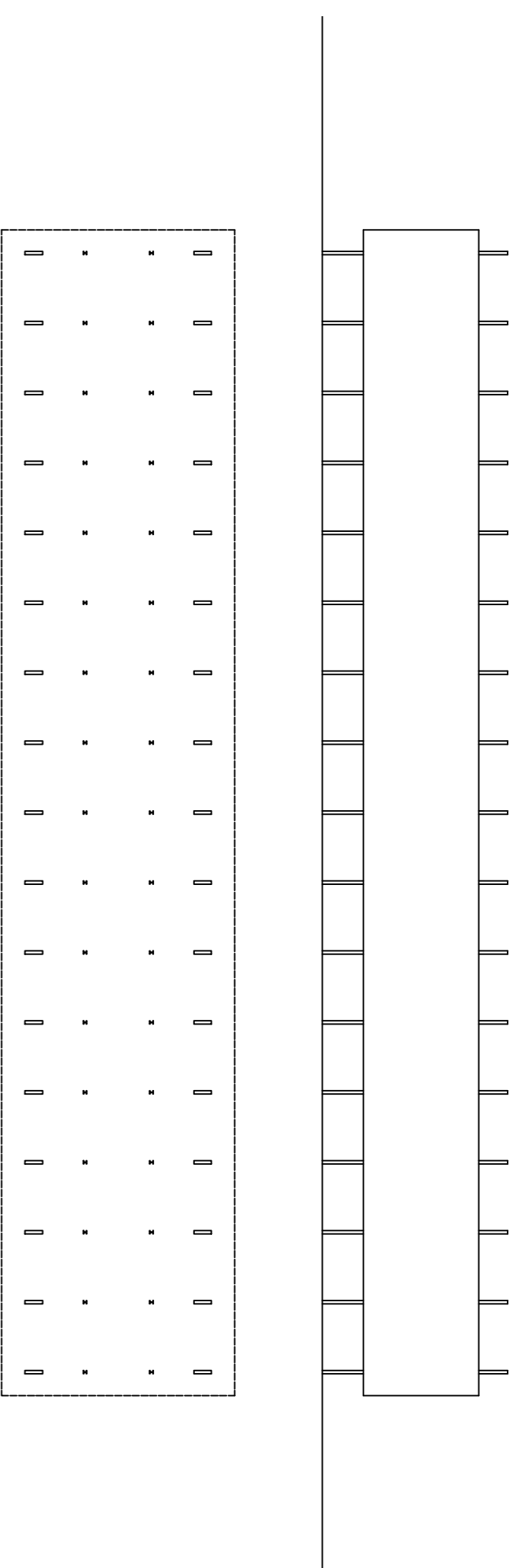

SEZIONE GENERALE DELLA BIBLIOTECA
E: 1/200

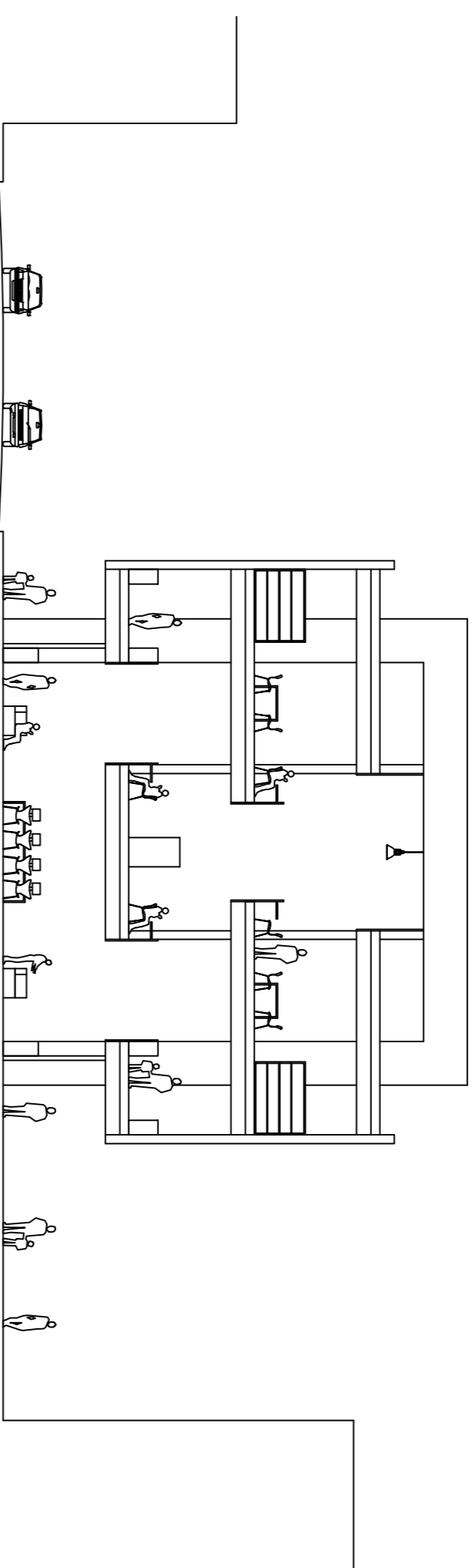

VISTA DELLA EMEROTECA DA EL PRIMO PIANO

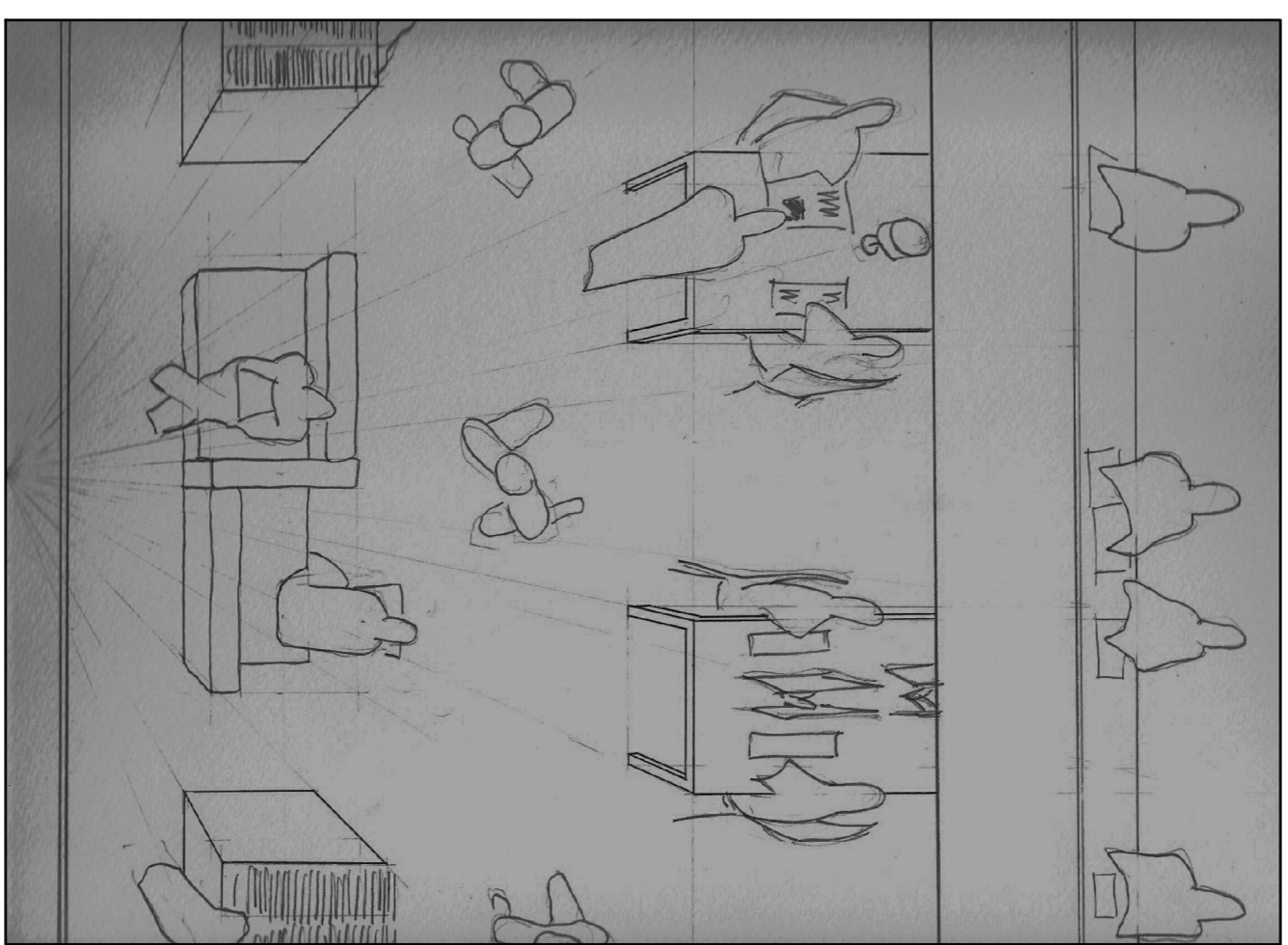

RIFERIMENTO (BELGIUM GENK PUBLIC LIBRARY)

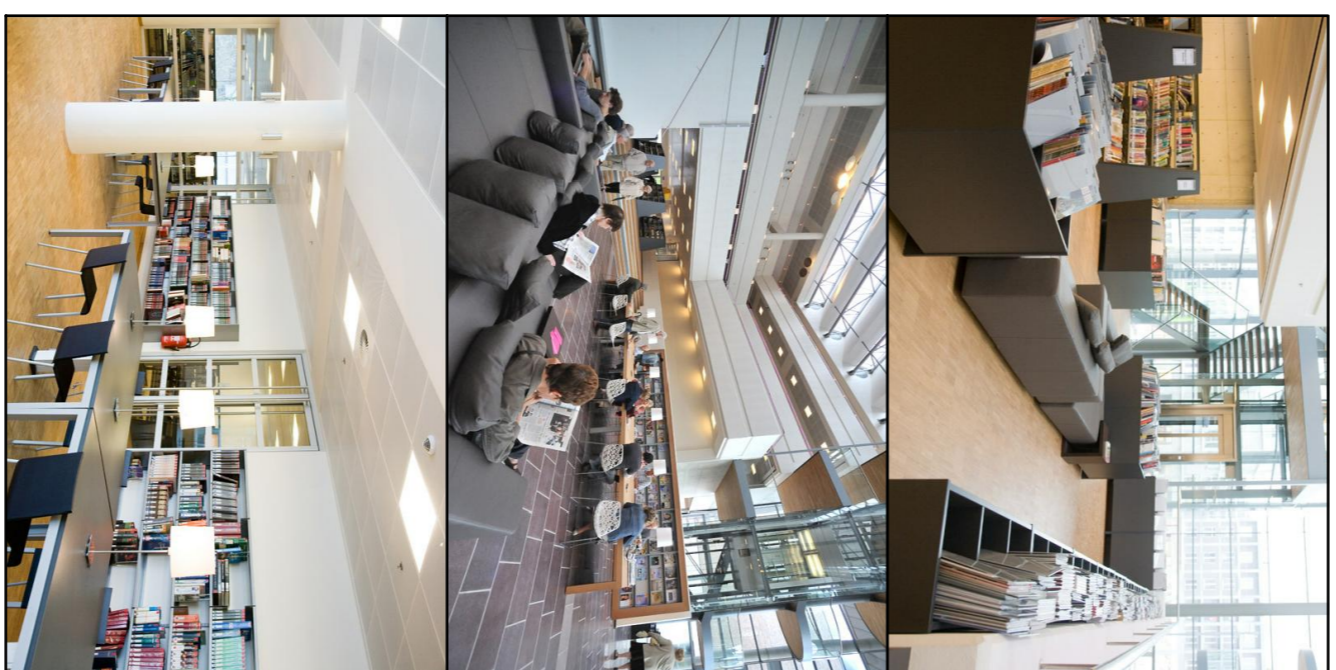

VISTA INTERNO DELLA EMEROTECA (PB)

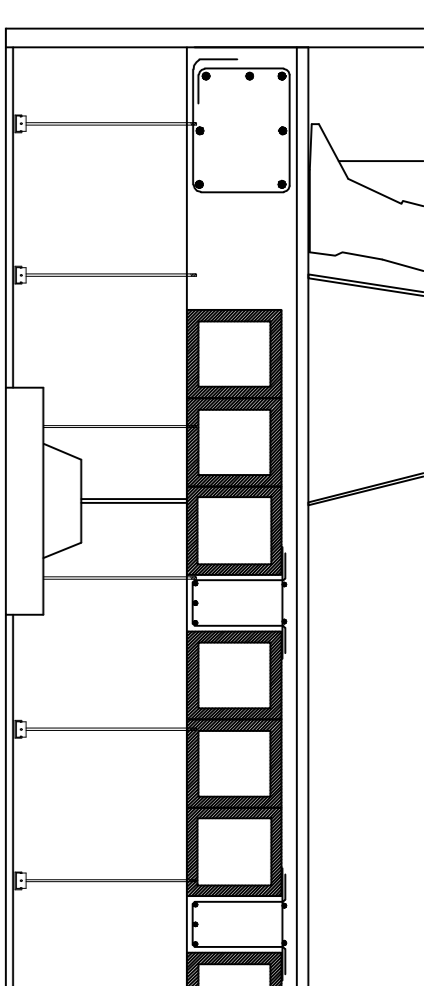
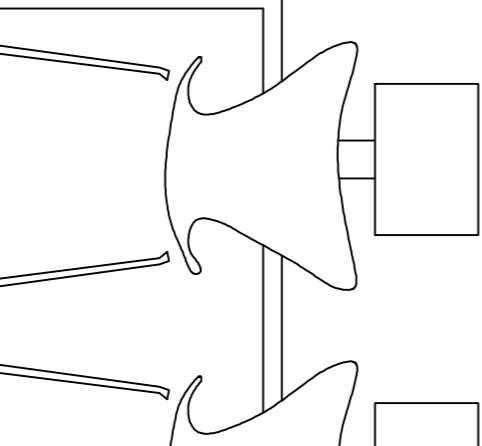
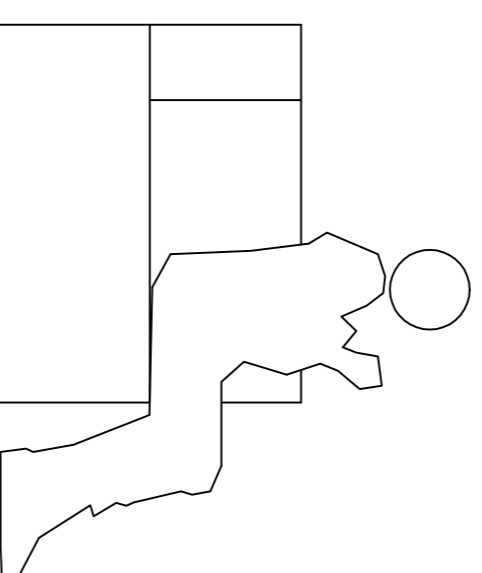
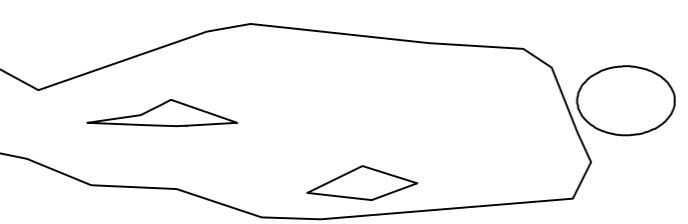
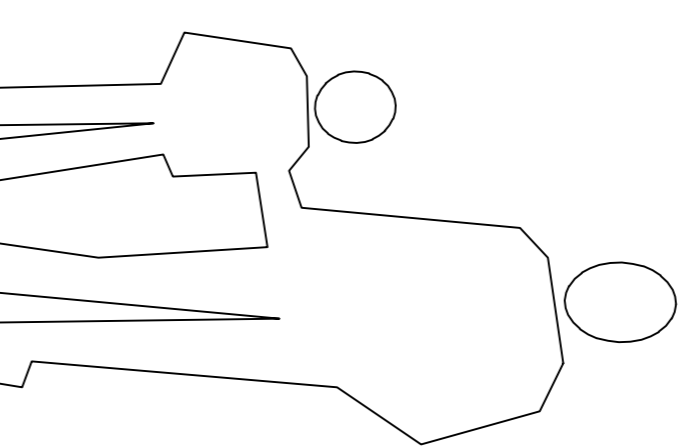
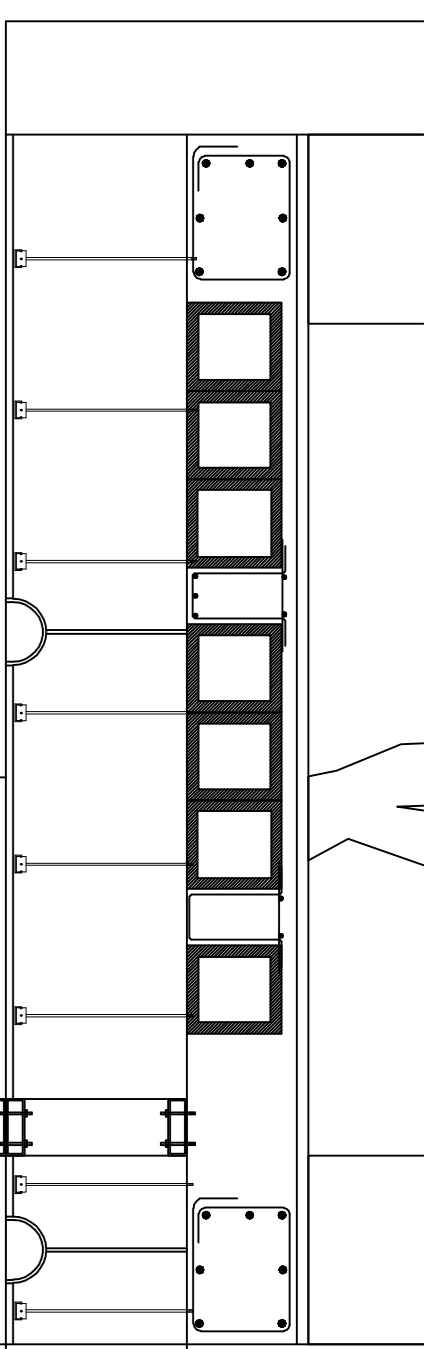

VIA FRANKLIN

SEZIONE (ALTEZZA DOPPIA - ENTRATA DELLA LUCE NATURA
E

ILLUMINAZIONE INTERNOESTERNO (GUZZINI)



FINESTRE DI ALLUMINIO PONTE TAGLIO TERMICO (TECHNAL)



PANNELLO ALUMINIO PER SOFFITTI SOSPESI (TRUCCELL)



PAVIMENTO QUARZO-VINILICO IN PIASTRELLE (HOMI RANGE)



PETRA - GRIS GRAFFIO 80X40X10 (BREINCO)

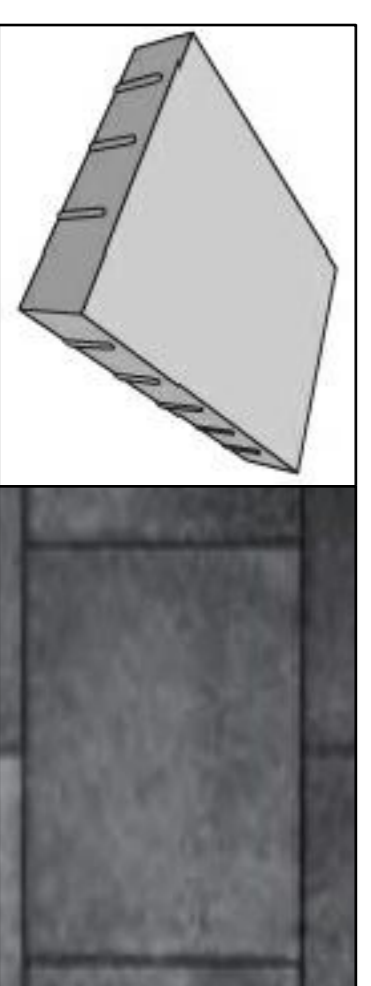

Laboratori di Progettazione 3M-A

prima fase 17-11-2011

BIBLIOTECA / EMEROTECA 5X5 M2

STUDENTE: RUBÉN SALMERÓN GONZÁLEZ (ERASMUS)

PROFESSORE: GIOVANNI LONGOBARDI

AREA OGGETTO DELL' APPROFONDIMENTO: 2

E:

